

Cruise control*

*: If equipped

Use the cruise control to maintain a set speed without depressing the accelerator pedal.

System Components

■ Meter display

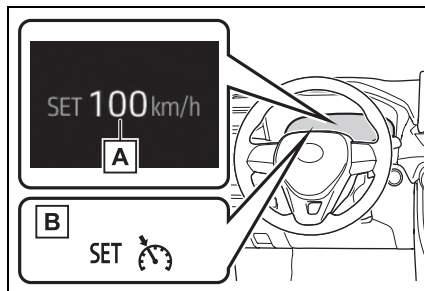

A Set speed

B Indicators

■ Operation switches

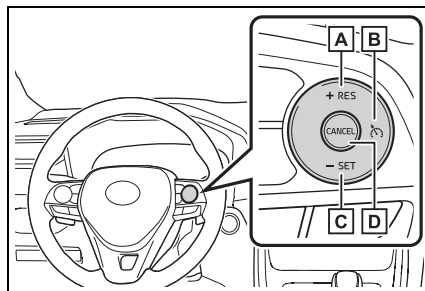

A "+RES" switch

B Cruise control main switch

C "-SET" switch

D Cancel switch

! WARNING

■ To avoid operating the cruise control by mistake

Switch the cruise control off using the cruise control main switch when not in use.

■ Situations unsuitable for cruise control

Do not use cruise control in any of the following situations. Doing so may result in loss of control and could cause an accident resulting in death or serious injury.

- In heavy traffic
 - On roads with sharp bends
 - On winding roads
 - On slippery roads, such as those covered with rain, ice or snow
 - On steep hills
Vehicle speed may exceed the set speed when driving down a steep hill.
 - When your vehicle is towing a trailer* or during emergency towing
- *: Vehicles that can tow a trailer.
(→P.294)

Setting the vehicle speed

- 1 Press the cruise control main switch to activate the cruise control.

Cruise control indicator will be displayed.
Press the switch again to deactivate the

cruise control.

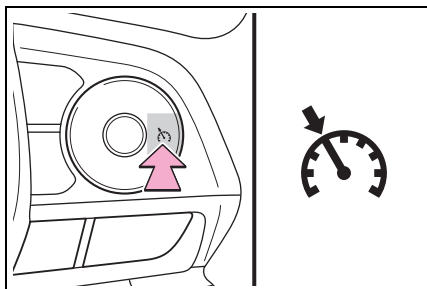

- 2** Accelerate or decelerate, with accelerator pedal operation, to the desired speed (at or above approximately 30 km/h [20 mph]) and press the “-SET” switch to set the speed.

Cruise control “SET” indicator will be displayed.

The vehicle speed at the moment the switch is released becomes the set speed.

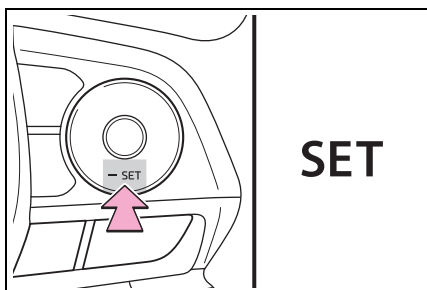

Adjusting the set speed

To change the set speed, operate the “+RES” or “-SET” switch until the desired set speed is obtained.

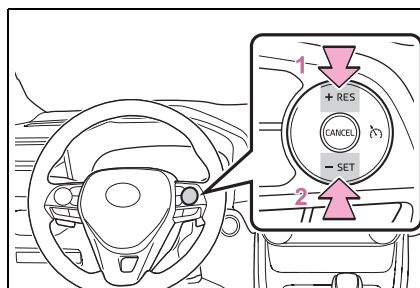

- 1** Increases the speed

- 2** Decreases the speed

Fine adjustment: Press the switch.

Large adjustment: Press and hold the switch to change the speed, and release when the desired speed is reached.

The set speed will be increased or decreased as follows:

Fine adjustment: By 1 km/h (0.6 mph)^{*1} or 1 mph (1.6 km/h)^{*2} each time the switch is operated.

Large adjustment: The set speed can be increased or decreased continually until the switch is released.

^{*1}: When the set speed is shown in “km/h”

^{*2}: When the set speed is shown in “MPH”